

WEETH HOME

Water Mill

Styling

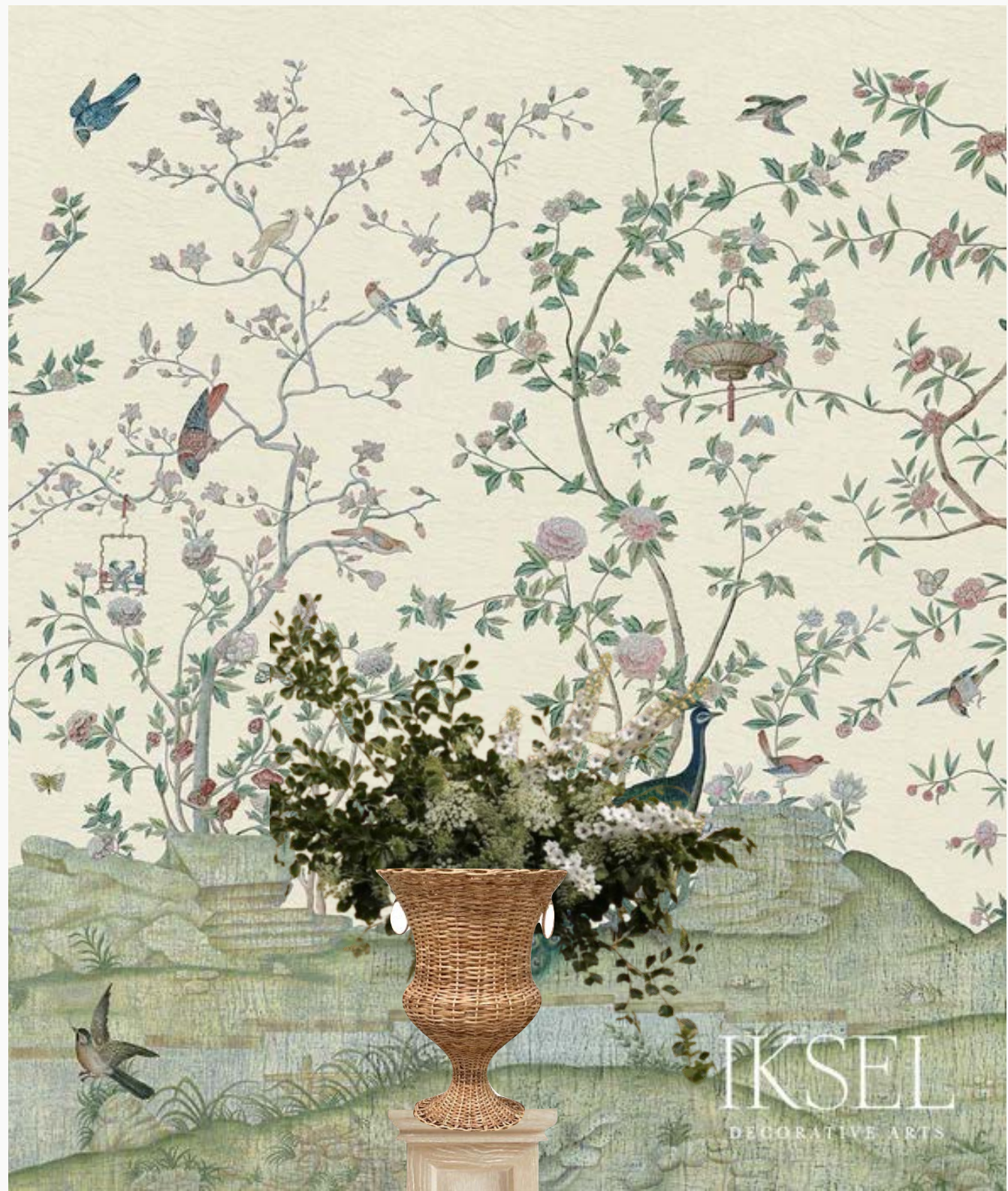
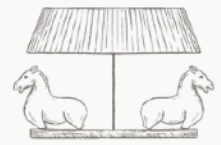

OPTION 1



Tablecloth



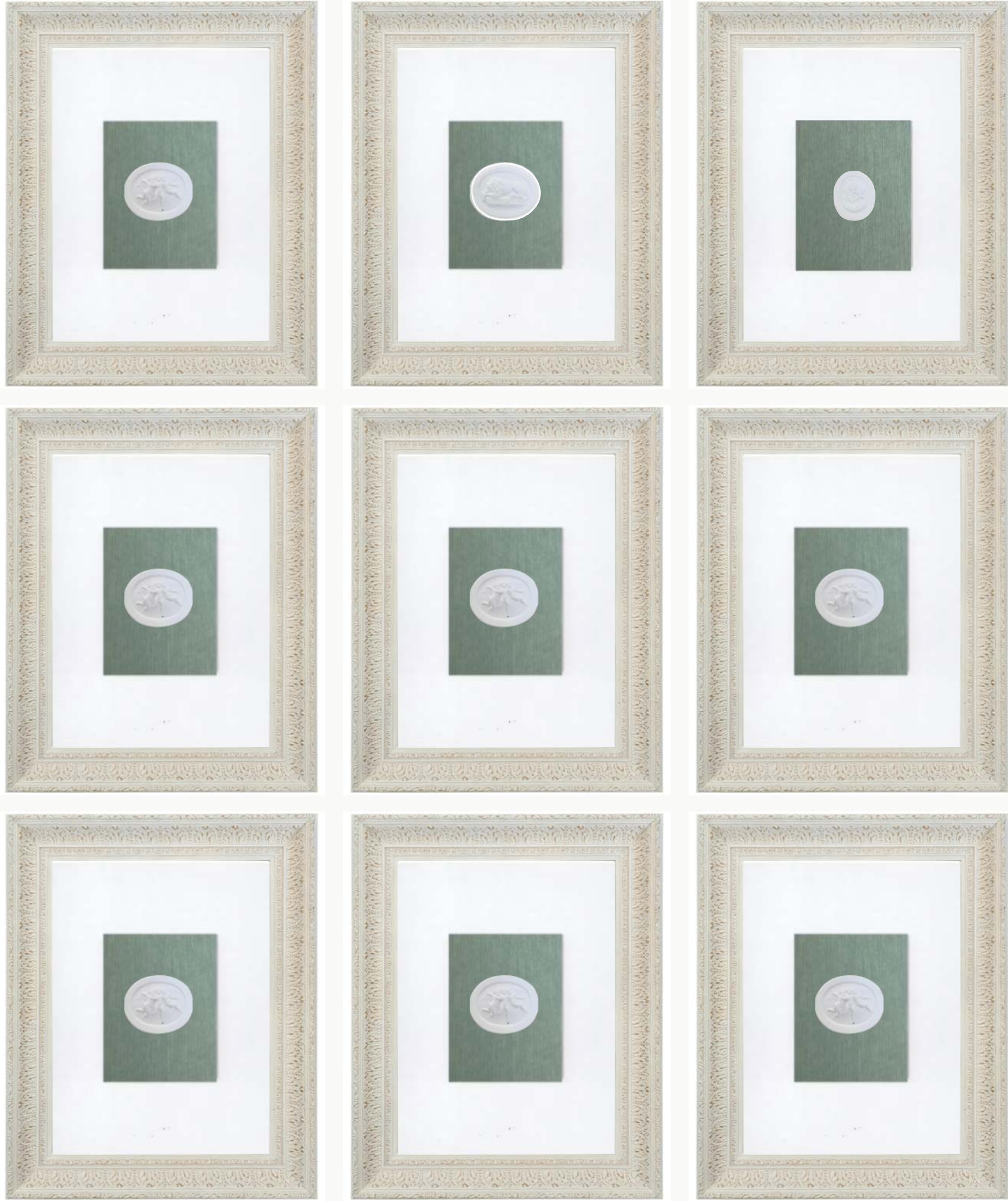
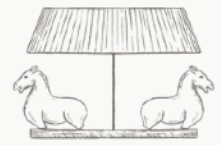

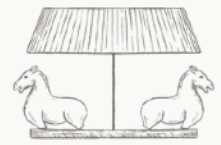

FRAME



BACKGROUND

Textured Olive

Custom Intaglios - We will do 9 out of these 11



Elevation for scale

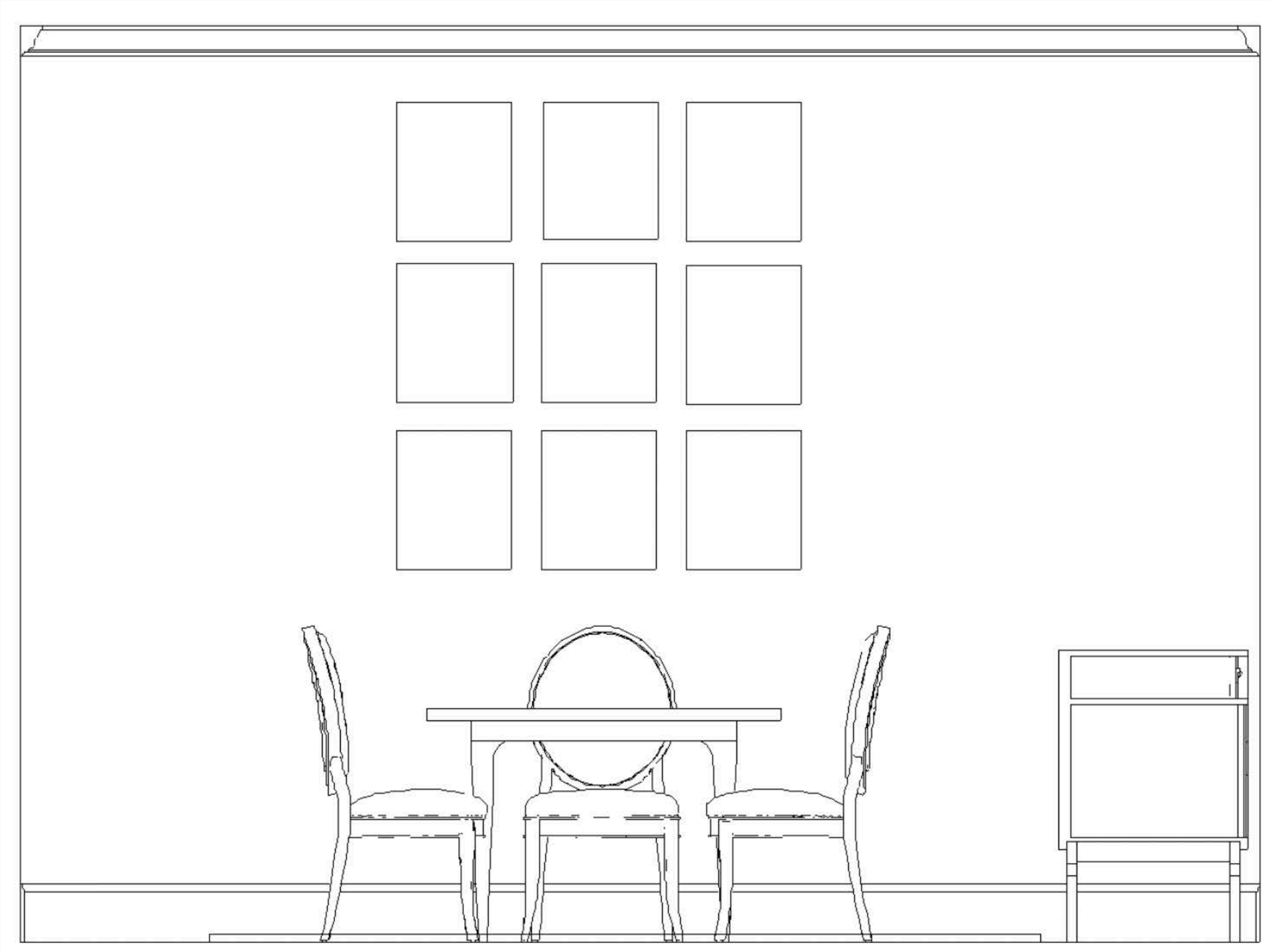

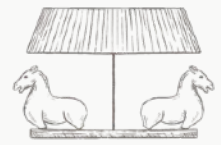

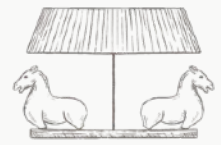

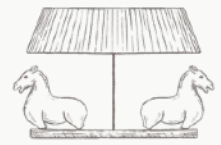

Demi-Lune Vessel - Option 1
Tage Anderson "Fold" Vessel



Demi-Lune Vessel - Option 2
Gerard De Witt Vase



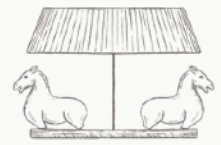

This is the direction for the collected gallery wall of vintage and prints

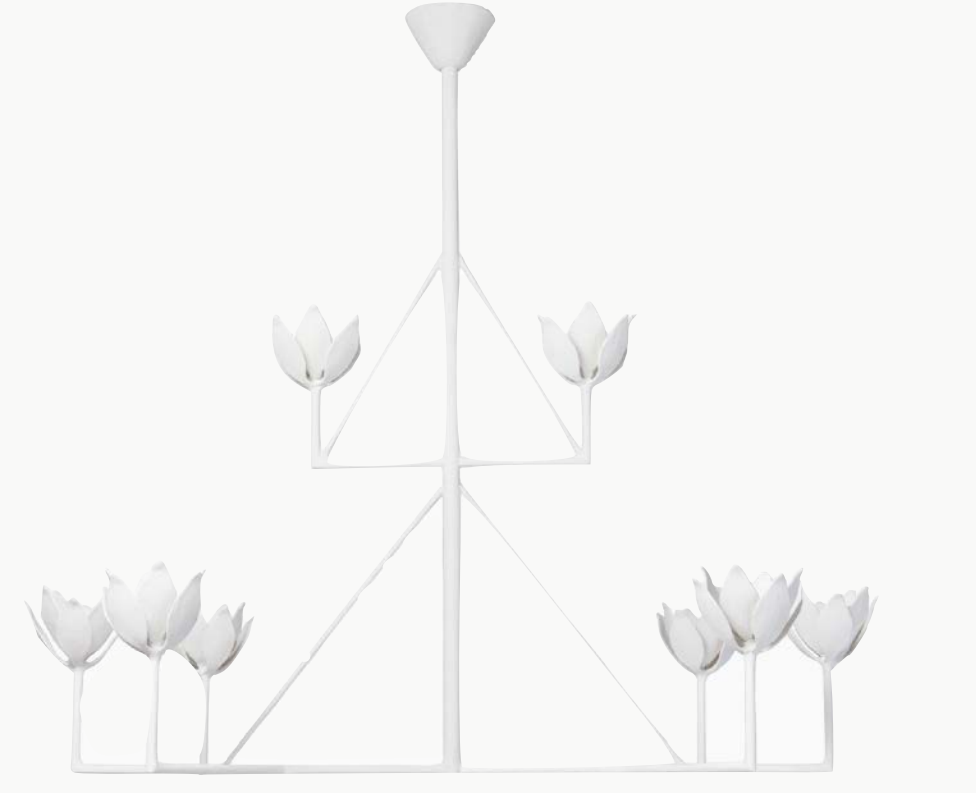

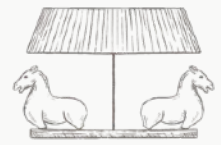

Direction for Bedding



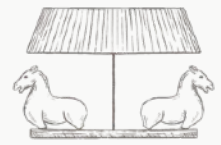

We like to make the door and drawer style look like this image (the top will be glass and we will add fabric panels inside)

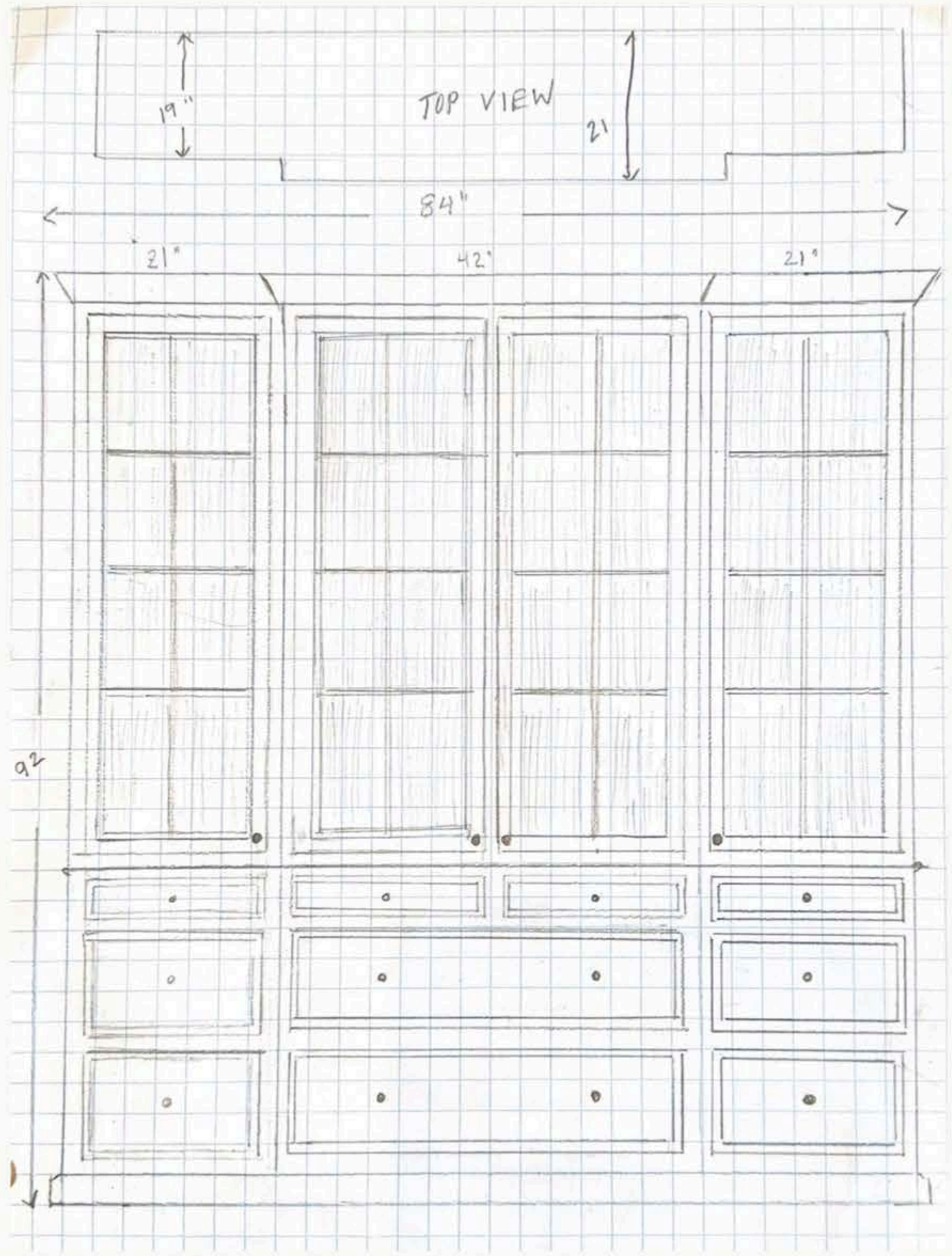

PRIMARY BEDROOM
Custom Cabinetry